

ESTECEM Plus Clinical Procedure Guide

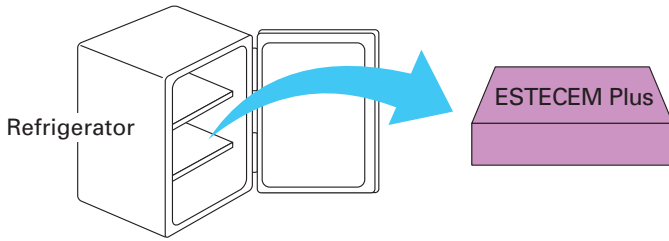

The PASTE and PALFIQUE UNIVERSAL BOND should be brought to room temperature before using.



After removing from the refrigerator, allow the product to sit for 20 minutes or until it reaches room temperature.

If the syringe is not brought up to room temperature, you will find it difficult to squeeze out the paste.
If the bottle is not brought up to room temperature, you will find it difficult to dispense one drop of liquid.

5254621704

Outline

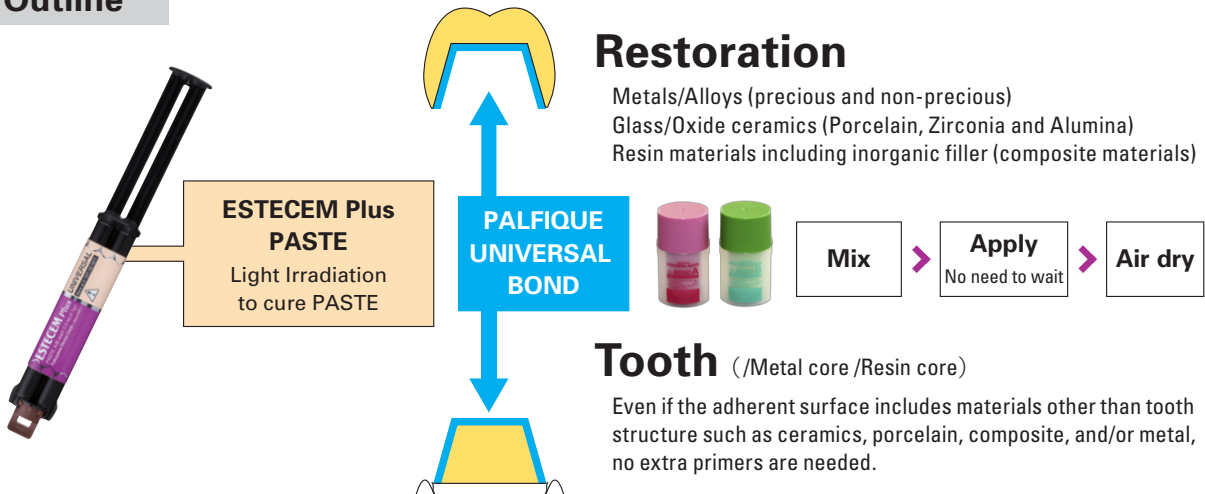

Point

How to dispense of PALFIQUE UNIVERSAL BOND

ESTECEM Plus KIT includes two types of mixing wells.

The rubber mixing well should be used for a single restoration, whereas the disposable mixing well should be used for multiple restorations. Each mixing well provides a different working time; 1 minute with the rubber mixing well and 3 minutes with the disposable mixing well.

1) Mixing Well

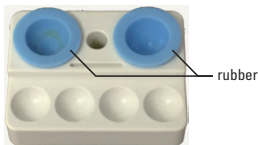

Complete the application within **1** minute of dispensing when using the mixing well.

Use the rubber provided when using the mixing well. If PALFIQUE UNIVERSAL BOND is not dispensed into the rubber it may be difficult to remove the cured PALFIQUE UNIVERSAL BOND from mixing well. The cured PALFIQUE UNIVERSAL BOND can be removed by inverting the rubber.

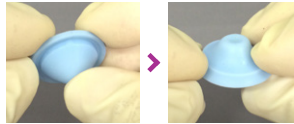

2) Disposable Mixing Well



Complete the application within **3** minutes of dispensing when using the disposable mixing well.

After mixing, the color of PALFIQUE UNIVERSAL BOND changes gradually based on the reaction of the catalyst of PALFIQUE UNIVERSAL BOND, this is normal and does not indicate a problem with PALFIQUE UNIVERSAL BOND.

How to attach the mixing tip

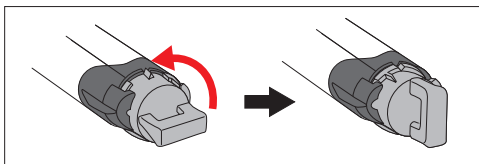

Turn the cap 1/4 of a turn counterclockwise to align the projections on the cap with the grooves in the syringe

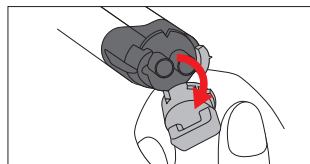

Holding the base of the cap, remove the cap by twisting and pressing downward

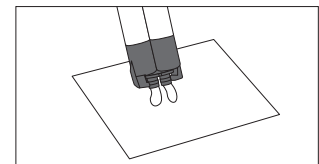

Before each use, squeeze out a small quantity of PASTE A and B, making sure equal amounts are being dispensed through the two outlets of the syringe

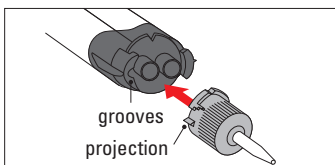

Attach a mixing tip to the syringe aligning the projections on the mixing tip with the grooves in the syringe as closely as possible

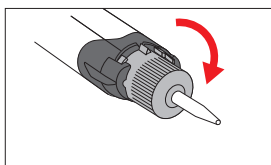

Turn the mixing tip 1/4 of a turn clockwise to lock it in place

Clinical Procedure Guide for ESTEC EM Plus

Read instruction before operation

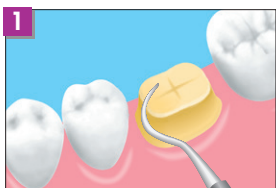

Tooth Preparation

Remove contamination from the tooth surface such as plaque, temporary cement residue, oil from materials to test crown fit, oil mist from a hand-piece, saliva, blood and exudate fluids by brushing with flour pumice, ultrasonic scaling or cleaning the surface of the tooth with alcohol. Thoroughly rinse and dry the surface.

Etching of the tooth structure (optional)

Clinically adequate adhesive bonds are achieved by the application of the adhesive. Selectively etching the enamel or using the "total etching procedure" can achieve higher adhesive values.

(a.) Selective-enamel-etch technique

Apply phosphoric acid gel only to the enamel surrounding the margin of prepared cavity and leave phosphoric acid gel in place for 10-15 seconds. Rinse the etched surface thoroughly (at least 15 seconds) with water, and then dry with mild air.

(b.) Total etch technique

Apply phosphoric acid gel onto the prepared enamel first, and then the dentin. The etchant should be left to react on the enamel and dentin for 10-15 seconds. Rinse thoroughly (at least 15 seconds) with water and dry with mild air or with cotton pellets; do not overdry.

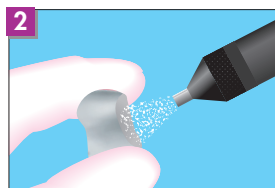

Restoration Preparation

Follow the procedure shown below, depending on the material to be restored.

1) Ceramics other than Porcelain, and Composite materials

Roughen the interior of the restoration by sandblasting (0.1 to 0.2MPa), air abrasion or grinding with a diamond bur using a slow speed to prepare the surface for adhesion.

2) Porcelain

DO NOT roughen the surface; Prepare the interior of the restoration, providing a clean and fresh surface for adhesion.

3) Metal restorations

Roughen the area by sandblasting (0.3 to 0.5MPa), air abrasion or grinding with a diamond bur using a slow speed to prepare the surface for adhesion.



Thoroughly rinse the surface

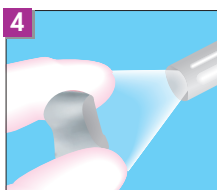

Dry the surface

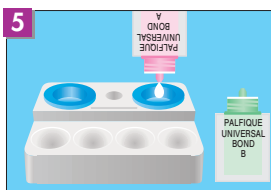

Restoration and Tooth Pretreatment with the PALFIQUE UNIVERSAL BOND

Dispense one drop each of PALFIQUE UNIVERSAL BOND A and B into the mixing well or disposable mixing well and mix.

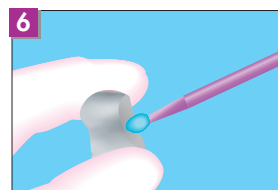

Apply the mixed bond on the surface of the restoration to be bonded.

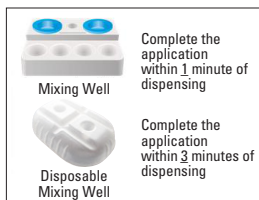

Complete the application within 1 minute of dispensing

Complete the application within 3 minutes of dispensing

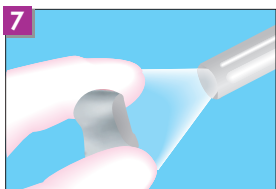

Apply mild air to the surface.

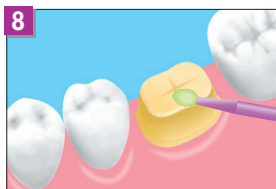

Apply the mixed bond on the surface of the tooth to be bonded.

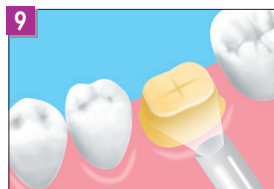

Apply weak air continuously to the surface until the runny bond stays in the same position without any movement, then mild air to the surface.

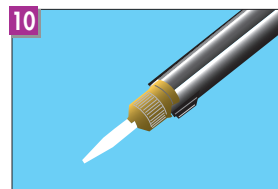

Cementation and Final Bonding

Attach a mixing tip to the syringe according to "How to attach the mixing tip".

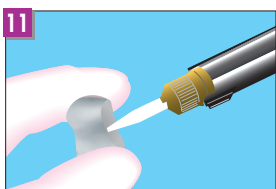

Apply the mixed PASTE to the surface of the restoration and place the restoration on the tooth with firm pressure.

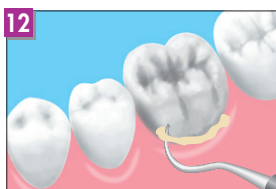

Removal of excess PASTE

- When using the light-cure method: Light-cure the excess PASTE with a dental curing light for 2 to 4 seconds and remove the gel state of the excess PASTE.

- When using the self-cure method: Remove the gel state of the excess PASTE within 1 to 3.5 minutes after seating.



Final PASTE hardening by light curing

- In case of translucent restoration materials such as ceramics:

Irradiate the light to the applied PASTE on the seated restoration for 20 seconds or more.

- In case of non translucent restoration materials such as metal:

Light-cure along margins for 20 seconds or more, then allow the PASTE to set for 8 minutes.

*If light curing is not enough, there is a possibility of poor adhesiveness.