

ESTECEM Clinical Procedure Guide

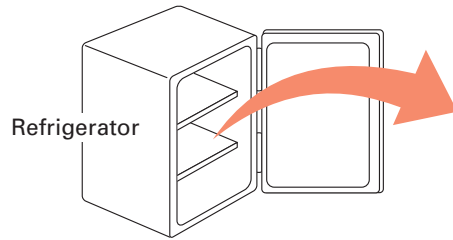

The PASTE, ESTELINK or TOKUYAMA UNIVERSAL PRIMER should be brought to room temperature before using.



After removing from the refrigerator, allow the product to sit for 20 minutes or until it reaches room temperature.

If the syringe is not brought up to room temperature, you will find it difficult to squeeze out the paste.
If the bottle is not brought up to room temperature, you will find it difficult to dispense one drop of liquid.

5254301411

Outline



Point

How to dispense of ESTELINK

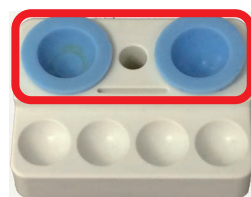

Use the rubber dispensing well provided when dispensing and mixing of ESTELINK. If ESTELINK is not dispensed into the rubber dispensing well it may be difficult to remove the cured ESTELINK from dispensing well. The cured ESTELINK can be removed by inverting the rubber.

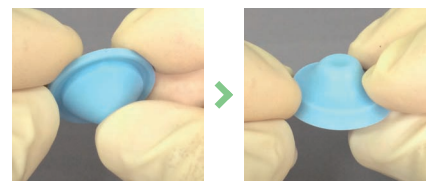

After mixing, the color of ESTELINK changes gradually based on the reaction of the catalyst of ESTELINK, this is normal and does not indicate a problem with ESTELINK.

How to attach the mixing tip

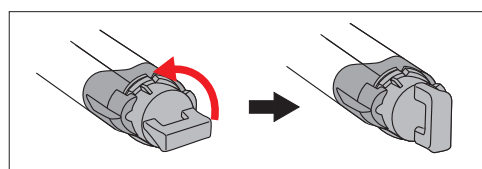

Turn the cap 1/4 of a turn counterclockwise to align the projections on the cap with the grooves in the syringe

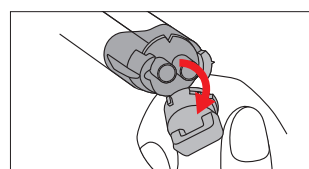

Holding the base of the cap, remove the cap by twisting and pressing downward

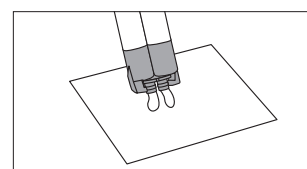

Before each use, squeeze out a small quantity of PASTE A and B, making sure equal amounts are being dispensed through the two outlets of the syringe

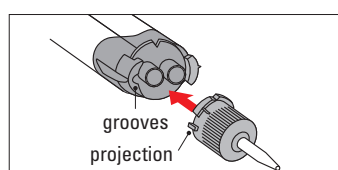

Attach a mixing tip to the syringe aligning the projections on the mixing tip with the grooves in the syringe as closely as possible

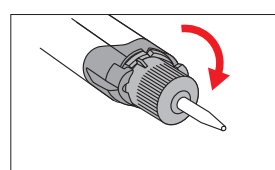

Turn the mixing tip 1/4 of a turn clockwise to lock it in place

Clinical Procedure Guide for ESTECM

Read instration before operation



1 Tooth Preparation

Remove contamination from the tooth surface such as plaque, temporary cement residue, oil from materials to test crown fit, oil mist from a hand-piece, saliva, blood and exudate fluids by brushing with flour pumice, ultrasonic scaling or cleaning the surface of the tooth with alcohol. Thoroughly rinse and dry the surface.

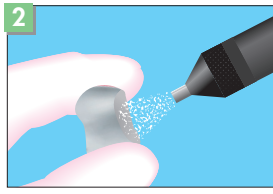

2 Restoration Preparation

Follow the procedure shown below, depending on the material to be restored.

- 1) Ceramics other than Porcelain, and Composite materials
Roughen the interior of the restoration by sandblasting (0.1 to 0.2MPa), air abrasion or grinding with a diamond bur using a slow speed to prepare the surface for adhesion.
- 2) Porcelain
DO NOT roughen the surface; Prepare the interior of the restoration, providing a clean and fresh surface for adhesion.
- 3) Metal restorations
Roughen the area by sandblasting (0.3 to 0.5MPa), air abrasion or grinding with a diamond bur using a slow speed to prepare the surface for adhesion.

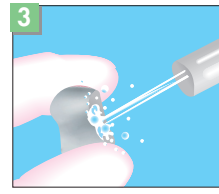

Thoroughly rinse the surface

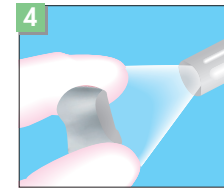

Dry the surface

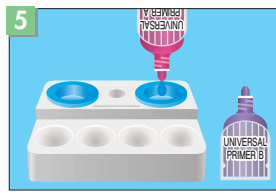

5 Restoration Pretreatment with the TOKUYAMA UNIVERSAL PRIMER

Dispense one drop each of TOKUYAMA UNIVERSAL PRIMER A and B into the dispensing well and mix.

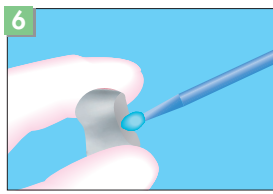

Apply the mixed primer on the surface to be bonded and wait 10 seconds.

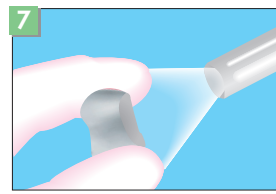

Apply mild air to the surface.

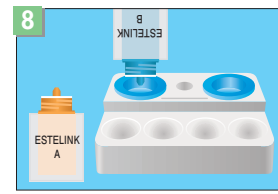

8 Tooth Pretreatment with the ESTELINK

Dispense one drop of ESTELINK BOND A and BOND B into the dispensing well and mix.

*Complete the application within 1 minute after dispensing.



Apply the mixed ESTELINK on the surface to be bonded and wait 10 seconds.

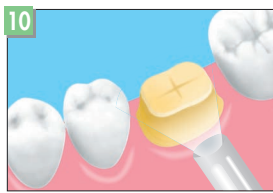

Apply mild air continuously to the surface until the runny ESTELINK stays in the same position without any movement, then strong air to the surface.

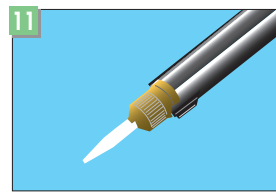

11 Cementation and Final Bonding

Attach a mixing tip to the syringe according to "How to attach the mixing tip".

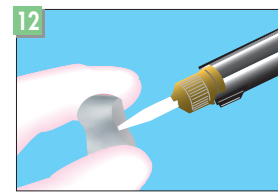

Apply the mixed PASTE to the surface of the restoration and place the restoration on the tooth with firm pressure.

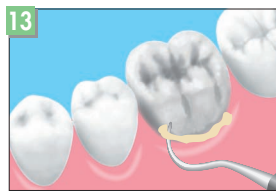

13 Removal of excess PASTE

- When using the light-cure method:
Light-cure the excess PASTE with a dental curing light for 2 to 4 seconds and remove the gel state of the excess PASTE.
- When using the self-cure method:
Remove the gel state of the excess PASTE within 1 to 3.5 minutes after seating.

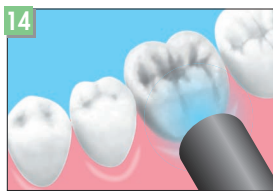

14 Final PASTE hardening by light curing

- In case of translucent restoration materials such as ceramics:
Irradiate the light to the applied PASTE on the seated restoration for 20 seconds or more.
- In case of non translucent restoration materials such as metal:
Light-cure along margins for 20 seconds or more, then allow the PASTE to set for 8 minutes.

*If light curing is not enough, there is a possibility of poor adhesiveness.